



SHOWER TRAY (WASTE NOT INCLUDED)

TRAY IMAGE FOR ILLUSTRATION PURPOSES ONLY **ASSEMBLY GUIDE APPLIES TO ALL WAIFER SLATE EFFECT TRAYS**

Tools and additional required



Spirit Level



Silicone

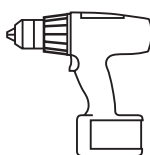

Drill

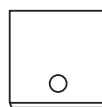

Hole Cutter



Pencil



Hammer

Before you start...

Check the pack and make sure all the components are included. When you are ready to start make sure you have all the right tools to hand, plenty of space and a clean dry area for building. Don't rush, read the instructions first and run through the assembly sequence before you begin.

ASSEMBLY INSTRUCTIONS: IMPORTANT PLEASE READ

Please read these instructions carefully. If in doubt please contact a qualified plumber. Failure to adhere to these instructions will invalidate the manufacturer's guarantee and no responsibility will be accepted for any loss or damage.

This does not affect your statutory rights.

Please inspect this product immediately for damage, size and colour. Do not install if not satisfied, as no claims for consequential damage will be accepted.

We recommend that 2 persons install the tray. It must be considered a 2 manlift at all times.

Ensure that the tray top surface is compatible with the intended shower enclosure taking into account loss of dimension from the tiles. This is particularly if you have elected to recess the edge of the tray into adjacent walls.

Do not use putty, mastic, solvent based sealers or high tack tape in direct contact with this product. Use of these will damage the tray and render the manufacturer's guarantee invalid.

We strongly recommend the use of a fast flow waste with this product.

PRIOR TO FITTING THE TRAY, PLEASE CHECK THE LEVEL AND THAT THE TRAY DRAINS CORRECTLY

Level Test - Place the tray at an elevated height using a spirit level across the front, sides and horizontal. Once level, please check the rim of the shower tray as this should have a slight fall into the tray. Once level you can now Water test, remove protective film and check for damage, place a bucket under the waste hole and pour water on the surface of the tray to make sure water drains away towards the drain hole, due to static, some large droplets may remain but large pools should not be evident.

Suspended floor installation

- 1 If the tray is to be installed onto a suspended floor, the total area of the tray (or bigger) must be removed and replaced with a single piece of birch ply or similar (min 18mm thick). If using a tray with a tiling upstand, allowance must be made for recessing the tray into the adjoining walls to allow tiling onto the surface of the tray.

N.B. On concrete floors the ply is not required. A trench for the trap and waste pipe will be required which gives sufficient access for connecting the plumbing once the tray is installed.

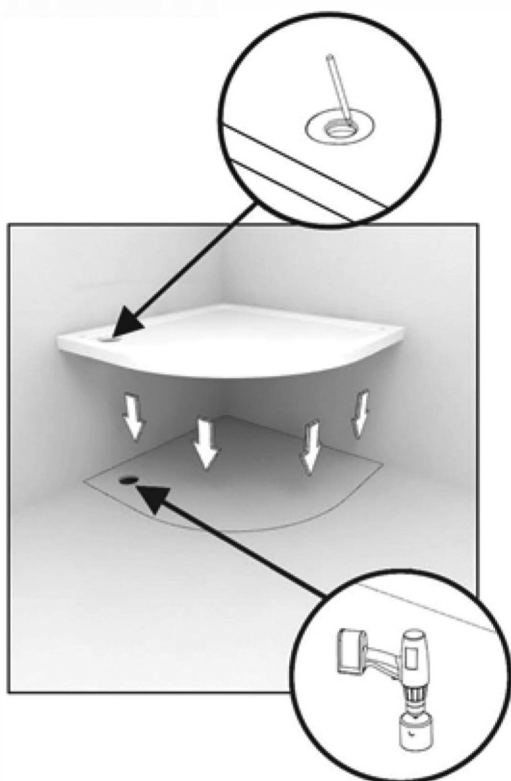
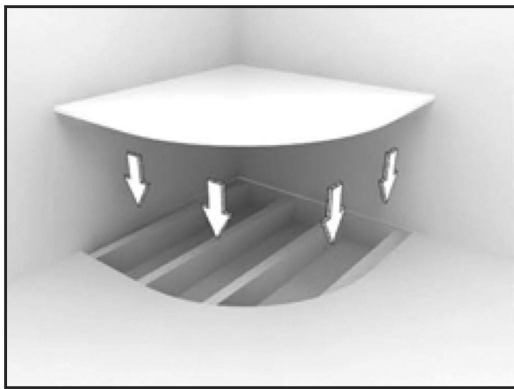

- 2 Cover the base with a full screed of a weak mix of sand and cement (5:1 ratio) or an alternative cement based tile adhesive. Spread the screed evenly where the base of the tray will sit, do not allow the mix to block the waste hole in the ply where applicable. Ensure the sufficient thickness to cover all voids to allow levelling and full support to the tray base and sides.

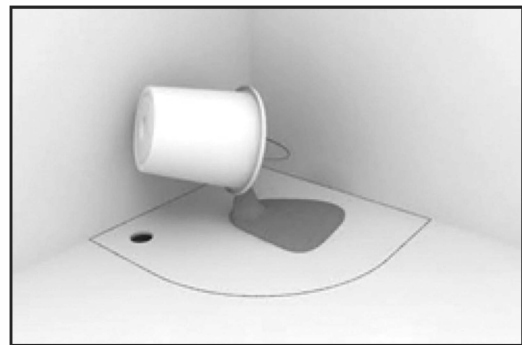

- 3 Fit the waste to the tray (as per the manufacturer's instruction) and position the tray on the ply & cement/sand mix. Be careful not to obstruct the waste under the tray as this may cause leakage. Ensure the tray is positioned against both walls. Ensure the tray is level using a spirit level. Connect the waste pipe to the waste and water, test the connections for leaks and tray water retention. Allow the cement/sand mix to set before commencing any further.

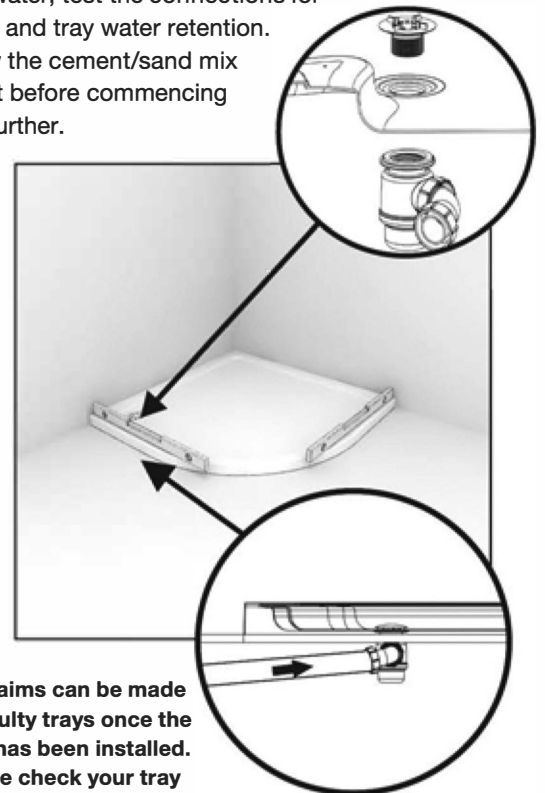

No claims can be made for faulty trays once the item has been installed. Please check your tray before installation.

- 4 Once the mortar mix is set, apply a secondary silicone seal between the tray and wall. Tile down onto the tray on each wall using suitable waterproof adhesive then grout the tiles using anti-fungal grout.

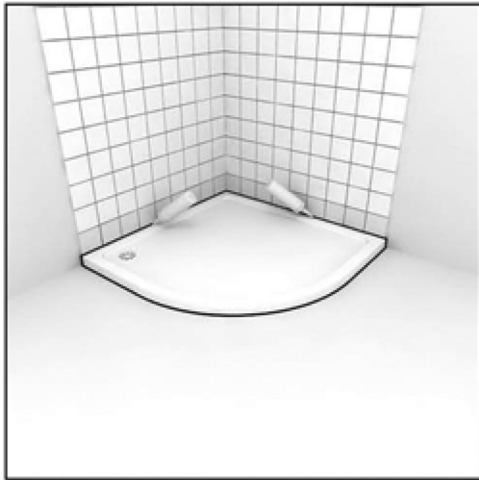

- 5 Make sure that all surfaces are clean, dry and dust free, then generously seal the joint between the tray and tiles and tray to floor with an anti-fungal silicone sealant. Ensure the silicone and grout is set before fitting the enclosure. We strongly recommend leaving for at least 48 hours.

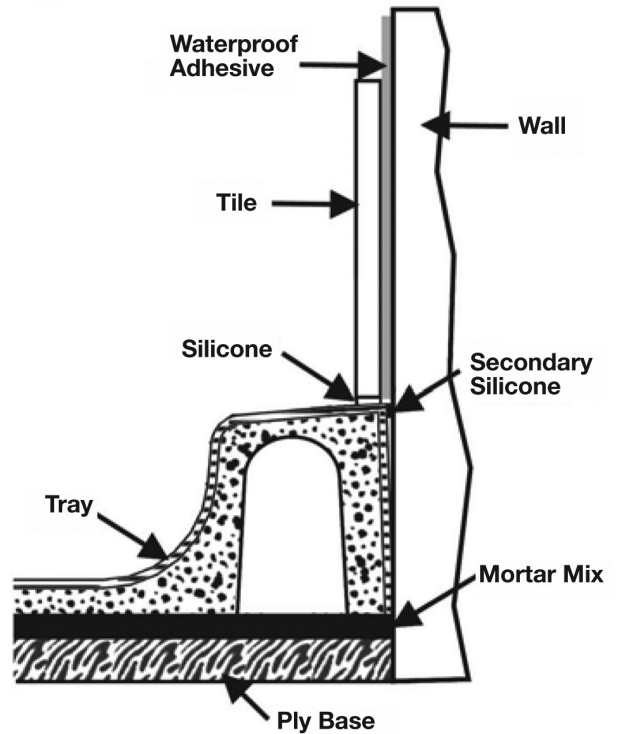

Solid floor installation

- 1 Construct a wooden plinth to suit the base of the tray. Allow adequate space below the plinth for the waste. Cut & fit an 18mm marine ply board to fit the plinth. Position the tray on the plinth & mark through the waste hole in the tray using a pencil. Cut the marked hole in the ply using a drill and hole cutter to suit the waste. The hole should be sufficient to allow the waste unit to tighten onto the base of the tray & not the ply.

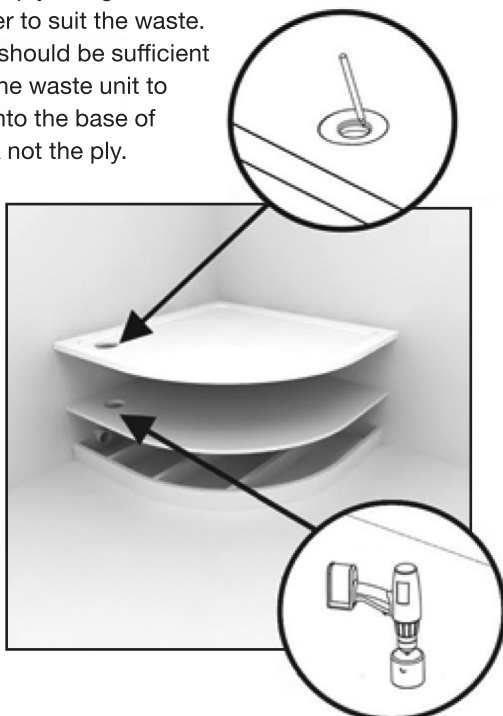

- 2 Cover the base with a full screed of a weak mix of sand & cement (5:1 ratio) or an alternative cement based tile adhesive. Spread the screed evenly where the base of the tray will sit, do not allow the mix to block the waste hole in the ply. Ensure sufficient thickness to cover all voids to allow levelling and full support to the tray base & sides.

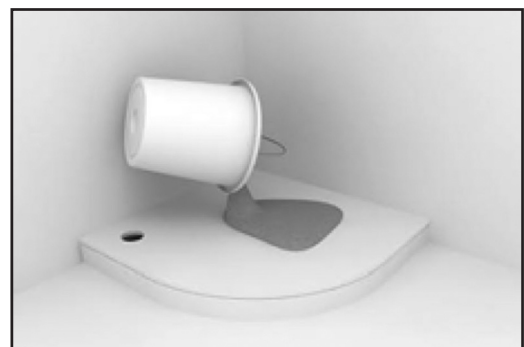

- ③ Fit the waste to the tray and position the tray on the ply and cement/sand mix. Be careful not to obstruct the waste hole under the tray as this may cause leakage. Ensure the tray is positioned against both walls. Ensure the tray is level using a spirit level.



- ④ Connect the waste pipe to the waste and water test the connections for leaks & tray water retention. Allow the mix to set before commencing any further.



- ⑤ Once the mortar mix is set, apply a secondary silicone seal between the tray and wall. Tile down onto the tray on each wall using suitable waterproof adhesive then grout the tiles using anti-fungal grout.



- ⑥ We recommend that you tile the plinth using the same method as used for the wall tiling. Make sure that all surfaces are clean, dry and dust free, then generously seal the joint between the tray and tiles (refer to step 5 image for more detail), tray to plinth and plinth to floor with an anti-fungal silicone sealant. Allow the silicone and grout to set before fitting the enclosure. We strongly recommend leaving for at least 48 hours.

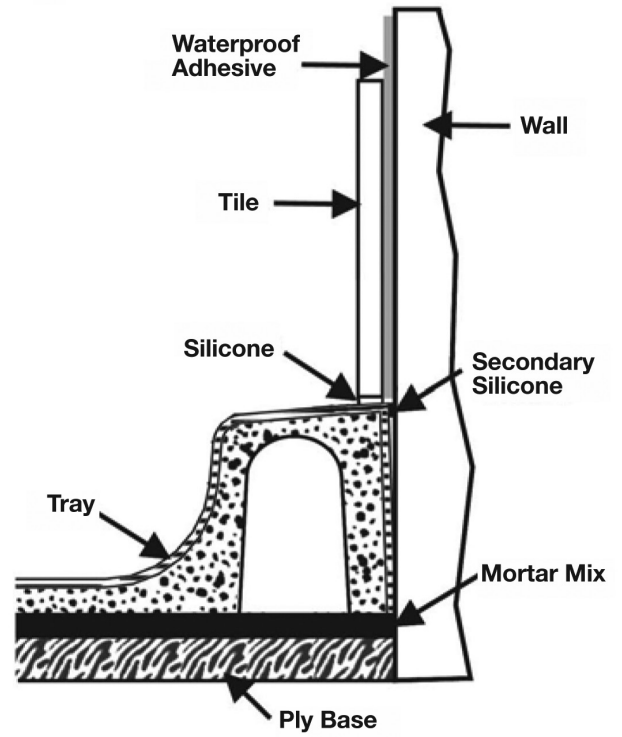

IMPORTANT

A complete watertight seal is essential, the floor and or the marine ply support could be damaged if water penetrates through.

AFTERCARE INSTRUCTIONS

After use the tray must be washed out with soap and water or a cleaner that is recommended for use with plastics, a soft bristle brush may be used for crevices, finish off by drying with a soft clean cloth.

Under no circumstances should harsh detergents, scouring powders, bleaches or solvent based products be allowed to come into contact with the surface of the tray.

If after use the shower tray is not cleaned as recommended minerals present in some water supplies may stain the shower tray. This staining is cosmetic only and affect the performance of the shower tray.

Prolonged contact with oil based products can, in some cases cause stress cracking of the shower tray surface, cleaning the shower tray as detailed in aftercare instructions part A will reduce the risk but not alleviate it.

If the shower tray is to be used in conjunction with a water softener, it is recommended that the advice of the relevant water authority is sought, requesting information on the possibility of the treated water leaching sediment from existing pipework, which in turn can leave deposits on the surface.